

# IED ENVIRONMENT AWARENESS

## LOOK FOR GROUND SIGNS

*e.g., disturbed earth, suspicious markings*



## DRIVE CAREFULLY

*Pay attention at slow down points (e.g., sharp corners, bridges, bottlenecks)*

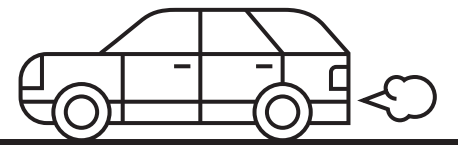
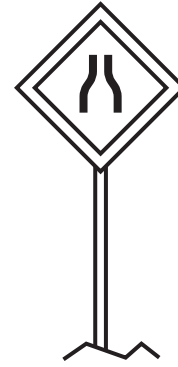

## VARY TRAVEL ROUTES

*Avoid setting patterns*

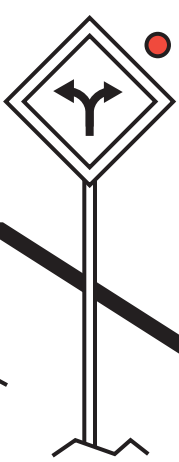

## REMAIN ALERT

*Prepare for blast waves, wear seat belts and secure baggage*

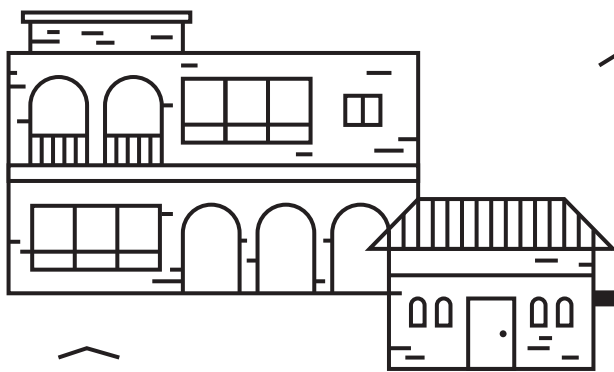

## HAS THE ENVIRONMENT CHANGED?

*Beware of unusual population behavior, such as locations that were once active and are now abandoned*



## DON'T PICK SOMETHING UP IF YOU DIDN'T PUT IT THERE

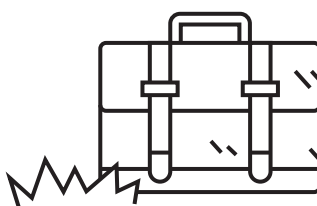

Don't become an IED statistic! If you find a suspected IED, immediately contact:



To learn more, download the UNMAS Landmine + ERW Safety app and visit us online at:

**UNMAS.ORG**